

LOTUS[®]
Performance, Delivered.[™]



Rotary Tool + 211PC Accs.

Made in China/Fabriqué en Chine
Lotus Tool Group (Philippines)
www.lotustoolworks.com

LRT170C



KNOW YOUR PRODUCT

ROTARY TOOL

- 1 Collet Nut
- 2 Shaft Collar
- 3 Spindle Lock Button
- 4 Accessible Brushes
- 5 On/off Switch
- 6 Variable Speed Dial
- 7 Hanging Ring

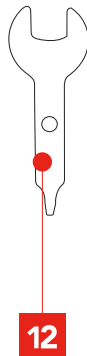
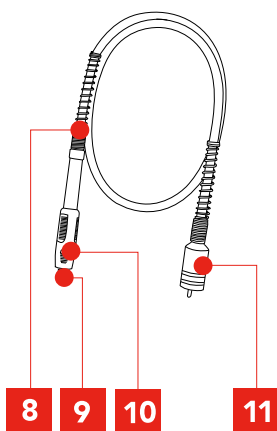
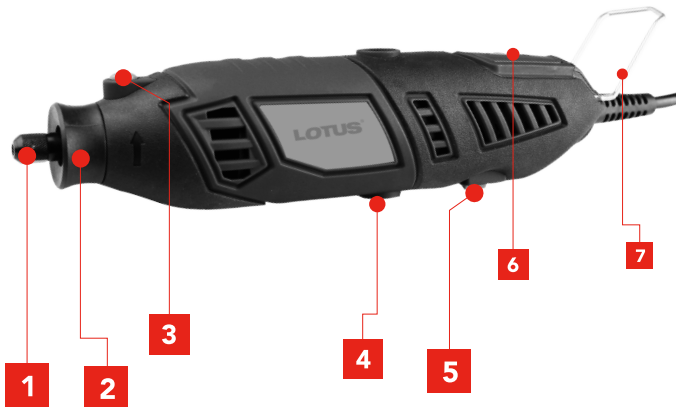

ACCESSORIES

- 8 Flexible Shaft
- 9 Locking Chuck
- 10 Spindle Lock
- 5 On/off Switch
- 6 Variable Speed Dial
- 7 Hanging Ring
- 11 Fitting Collar
- 12 Spanner

SETUP & PREPARATION

1. CHANGING ACCESSORIES

Ensure the tool is disconnected from the power supply before performing any of the following operations.

1. Press and hold the spindle lock button.

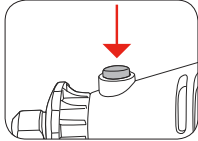

2. Unscrew the collet nut. Remove completely.

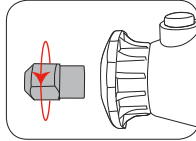

3. Select a suitable collet for the accessory to be used and insert. Then cover with collet nut.

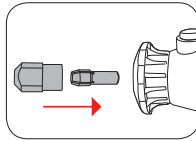

4. Slightly hand tighten the collet nut so that it stays in place.

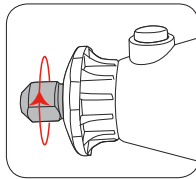

4. Insert shaft of accessory into the collet.

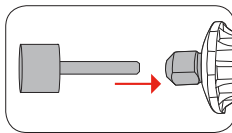

5. Tighten collet nut using spindle lock and spanner.

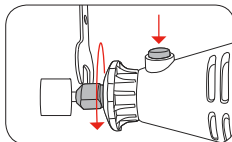

2. CHANGING ACCESSORIES CONT.

Locating a cutting/sanding disc

1. Remove the screw from the end of the disc holder.

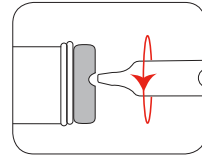

2. Fit the fibre flange either side of the cutting disc, then insert the screw.

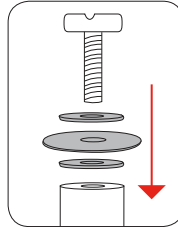

3. Tighten the cutting disc onto the cutting disc holder.

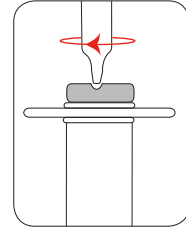

Note: Do not over-tighten the screw as it could result in damage to the cutting disc.

Locating a sanding drum

1. Loosen the screw on the top of the sanding drum holder.

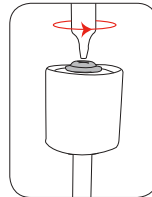

2. Slide the sanding drum onto the sanding drum holder.

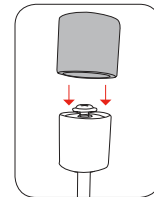

3. Tighten the screw until the sanding drum sleeve is secured.

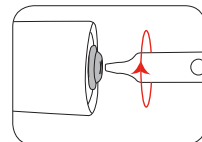

3. FLEXIBLE SHAFT

1. Remove the shaft collar.

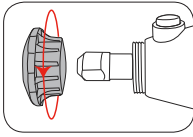

2. Loosen the collet nut.

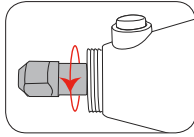

3. Raise the handle end of the flexible shaft & shake gently until the inner flexible shaft protrudes from the fitting collar.

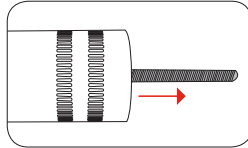

5. Insert the inner flexible shaft into the collet then tighten the collet nut.

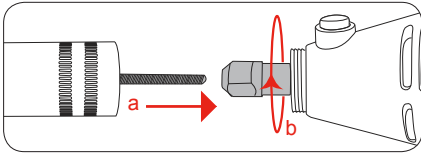

6. Screw the flexible shaft fitting collar onto the rotary tool.

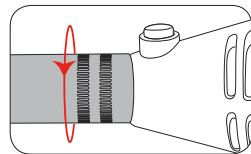

7. Insert the hex key into the hole on the handle.

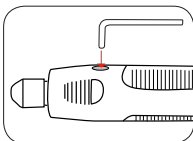

8. Loosen collet nut then insert shank of accessory into collet.

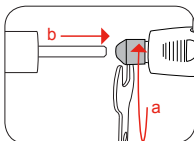

Tighten collet nut and check all fittings to ensure they are securely fastened.

OPERATION

4. CONTROLS

The tool is recommended for use with a residual current device with a rated residual current of 30mA or less.

Variable Speed Dial

Scroll through the variable speed dial to select the appropriate speed.

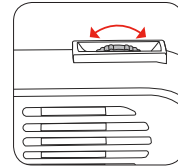

Note: The higher the number on the variable speed dial the faster the oscillation frequency of the rotary tool.

On/Off Switch

To turn on, set the variable speed dial to 1 then push the on/off switch to "1".

To turn off, set the variable speed dial to 1 then push the on/off switch to "0".

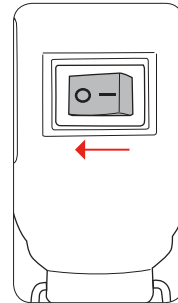
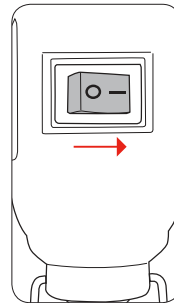

5. OPERATING THE ROTARY TOOL

1. Turn the rotary tool on.

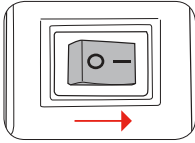

2. Select the appropriate speed for the application.

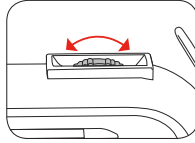

3. For high precision applications such as engraving or milling, hold the rotary tool like a pen.

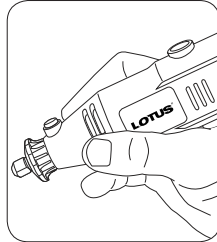

4. For heavy work like cutting or grinding, hold the rotary tool in the palm of your hand.

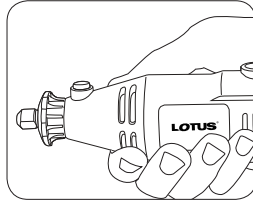

5. Gently apply the tip of the accessory to the workpiece.

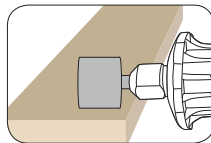

CAUTION: PLACING EXCESSIVE LOAD ON THE ROTARY TOOL WHILE IT IS RUNNING AT LOW SPEEDS MAY CAUSE IT TO OVERHEAT AND THE MOTOR TO FAIL.

TECHNICAL SPECIFICATIONS

Available Voltages
Maximum Output
No Load Speed
Collet chuck capacity

220V-240/50Hz-60Hz
170 Watt
8,000 - 35,000 rpm
Max3.2mm dia.

IMPORTANT! – Safety Instructions for all tools

WARNING: When using electric power tools, important safety precautions must always be adhered to in order to reduce the risk of fire, electric shock and personal injury.

PLEASE READ THE FOLLOWING CAREFULLY:

1. KEEP WORK AREA CLEAN. Untidy benches and work areas invite injuries.
2. CONSIDER WORK AREA ENVIRONMENT. Do not use power tools in damp or wet locations. Do not expose power tools to rain. Keep work areas well lit.
3. GUARD AGAINST ELECTRIC SHOCK. Prevent body contact with grounded surfaces. Eg. Radiators, pipes, refrigerator enclosures.
4. KEEP CHILDREN AWAY. All visitors must be kept away from the work area. Do not let visitors come into contact with the tool or extension cord.
5. STORE IDLE TOOLS. When not in use, tools must be stored in a dry place, out of reach of children.
6. DO NOT FORCE THE TOOL. It will do the job in hand better and safer at the rate for which it was intended.
7. USE THE RIGHT TOOL. Do not force a small tool to do the job of a heavy duty power tool. Do not use the tool for the purpose it is not intended for.
8. DRESS PROPERLY. Do not wear loose clothing or jewellery, as these can be caught in moving parts. Gloves and non-skid footwear are recommended when working outdoors. Wear protective head cover to contain long hair.
9. USE SAFETY GLASSES. Also use face and dust mask to guard against dust.
10. DO NOT ABUSE THE CORD. Never carry the tool by the cord or pull the cord to disconnect the tool. Keep the cord away from heat, oil or sharp objects.
11. SECURE YOUR WORK. Use clamps or a vice to hold your work in position. It is much safer than using your hand and it frees both hands to operate the tool.
12. DO NOT OVERREACH. Keep proper footing and balance at all times.
13. MAINTAIN TOOLS WITH CARE. Keep tools clean for better and safer performance. Follow instructions for lubricating and changing accessories. Keep hands dry, clean and free from oil and grease.
14. DISCONNECT TOOLS. When not in use, before servicing and when changing any accessories.
15. REMOVE ADJUSTING KEYS AND WRENCHES. Have the habit to check and see that keys and adjusting wrenches are removed from the tool before turning on.

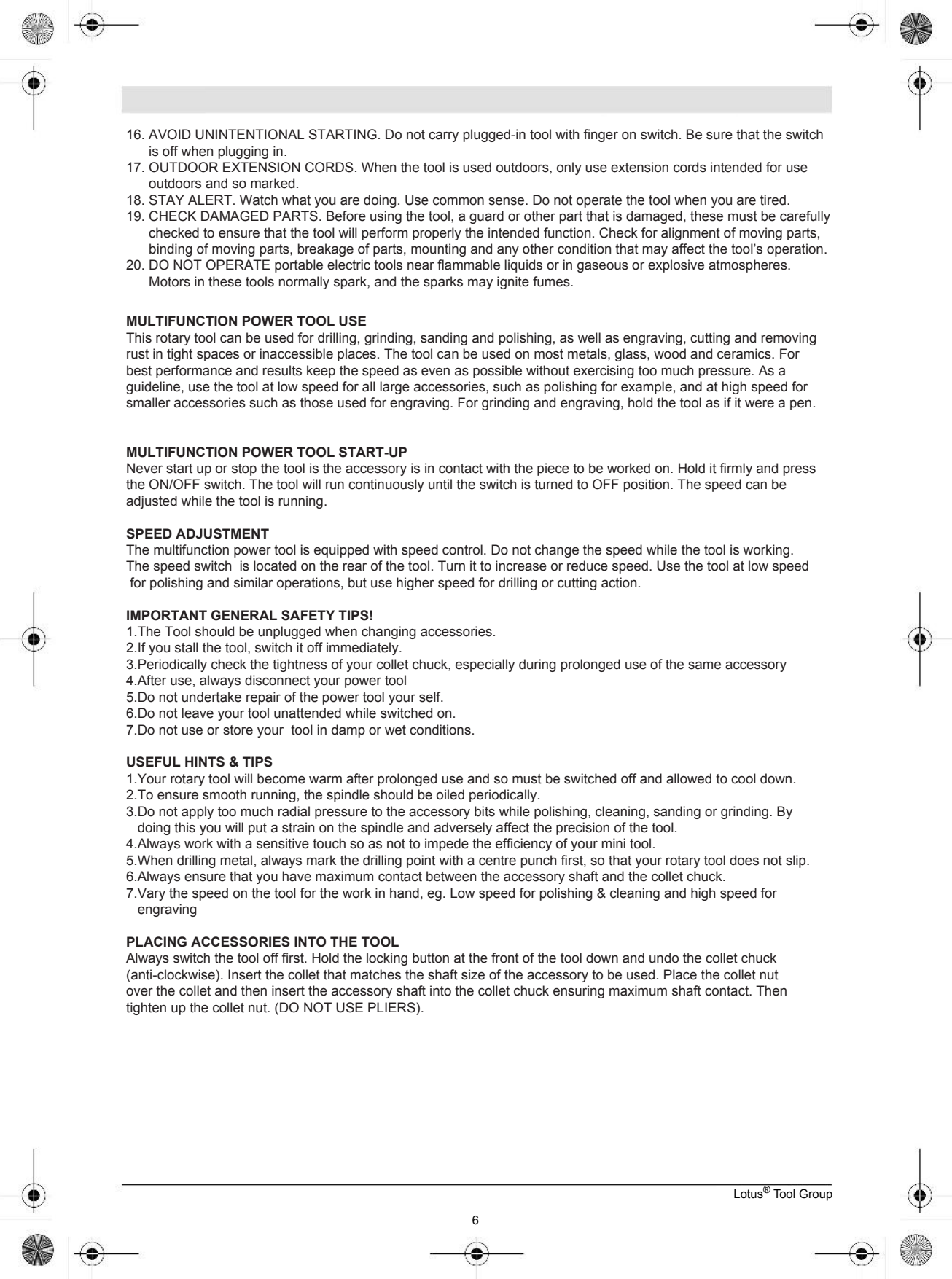
- 
16. **AVOID UNINTENTIONAL STARTING.** Do not carry plugged-in tool with finger on switch. Be sure that the switch is off when plugging in.
17. **OUTDOOR EXTENSION CORDS.** When the tool is used outdoors, only use extension cords intended for use outdoors and so marked.
18. **STAY ALERT.** Watch what you are doing. Use common sense. Do not operate the tool when you are tired.
19. **CHECK DAMAGED PARTS.** Before using the tool, a guard or other part that is damaged, these must be carefully checked to ensure that the tool will perform properly the intended function. Check for alignment of moving parts, binding of moving parts, breakage of parts, mounting and any other condition that may affect the tool's operation.
20. **DO NOT OPERATE** portable electric tools near flammable liquids or in gaseous or explosive atmospheres. Motors in these tools normally spark, and the sparks may ignite fumes.

MULTIFUNCTION POWER TOOL USE

This rotary tool can be used for drilling, grinding, sanding and polishing, as well as engraving, cutting and removing rust in tight spaces or inaccessible places. The tool can be used on most metals, glass, wood and ceramics. For best performance and results keep the speed as even as possible without exercising too much pressure. As a guideline, use the tool at low speed for all large accessories, such as polishing for example, and at high speed for smaller accessories such as those used for engraving. For grinding and engraving, hold the tool as if it were a pen.

MULTIFUNCTION POWER TOOL START-UP

Never start up or stop the tool is the accessory is in contact with the piece to be worked on. Hold it firmly and press the ON/OFF switch. The tool will run continuously until the switch is turned to OFF position. The speed can be adjusted while the tool is running.

SPEED ADJUSTMENT

The multifunction power tool is equipped with speed control. Do not change the speed while the tool is working. The speed switch is located on the rear of the tool. Turn it to increase or reduce speed. Use the tool at low speed for polishing and similar operations, but use higher speed for drilling or cutting action.

IMPORTANT GENERAL SAFETY TIPS!

1. The Tool should be unplugged when changing accessories.
2. If you stall the tool, switch it off immediately.
3. Periodically check the tightness of your collet chuck, especially during prolonged use of the same accessory
4. After use, always disconnect your power tool
5. Do not undertake repair of the power tool your self.
6. Do not leave your tool unattended while switched on.
7. Do not use or store your tool in damp or wet conditions.

USEFUL HINTS & TIPS

1. Your rotary tool will become warm after prolonged use and so must be switched off and allowed to cool down.
2. To ensure smooth running, the spindle should be oiled periodically.
3. Do not apply too much radial pressure to the accessory bits while polishing, cleaning, sanding or grinding. By doing this you will put a strain on the spindle and adversely affect the precision of the tool.
4. Always work with a sensitive touch so as not to impede the efficiency of your mini tool.
5. When drilling metal, always mark the drilling point with a centre punch first, so that your rotary tool does not slip.
6. Always ensure that you have maximum contact between the accessory shaft and the collet chuck.
7. Vary the speed on the tool for the work in hand, eg. Low speed for polishing & cleaning and high speed for engraving

PLACING ACCESSORIES INTO THE TOOL

Always switch the tool off first. Hold the locking button at the front of the tool down and undo the collet chuck (anti-clockwise). Insert the collet that matches the shaft size of the accessory to be used. Place the collet nut over the collet and then insert the accessory shaft into the collet chuck ensuring maximum shaft contact. Then tighten up the collet nut. (DO NOT USE PLIERS).

FLEXYDRIVE ASSEMBLY

Remove the front ring nut from the tool by turning in an anti-clockwise direction. Partially unscrew the blocking ring nut from the spindle. Partially extract the internal transmission cable from the flexydrive. Insert the flexydrive transmission cable into the spindle of the tool pushing it in as far as possible. Keep the spindle block button pressed in and screw the spindle blocking ring nut turning it in a clockwise direction. Tighten using the spanner for this purpose. Screw the threaded end of the flexydrive onto the body of the tool and tighten, screwing in a clockwise direction.

CHANGING THE INSERT AND ACCESSORIES ON THE FLEXYDRIVE

To change the insert or to install accessories on the flexydrive, follow the same general procedure for insert change and for accessory assembly on the attachment. To block the spindle, turn it until the hole in the shaft is in line with the hole on the handle of the flexydrive. Insert a 1/8" drill bit in the aligned holes to block the shaft.

